

Fastener Location
18 places
(see fastener detail)

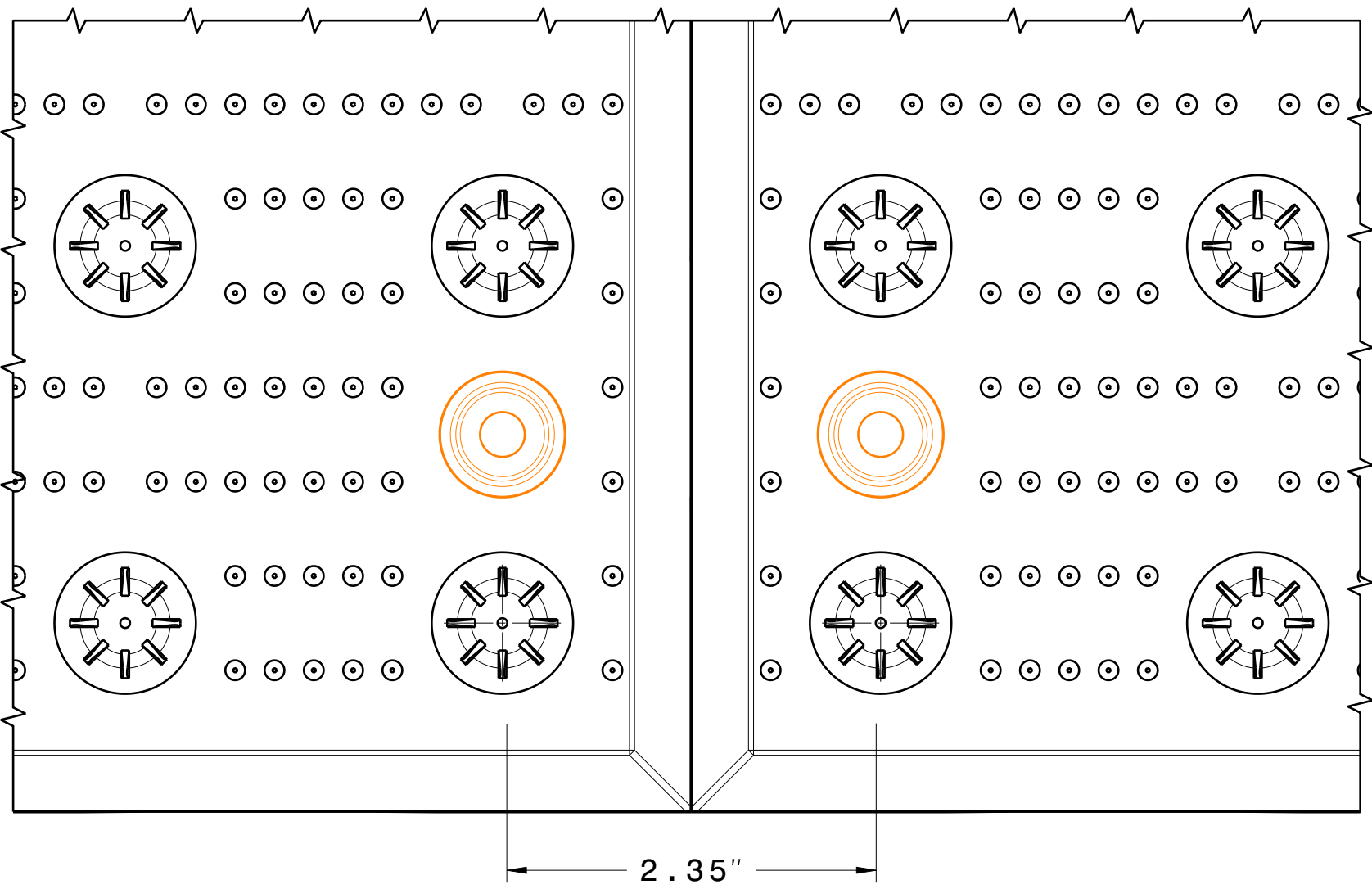

PLAN VIEW: 2-PANEL

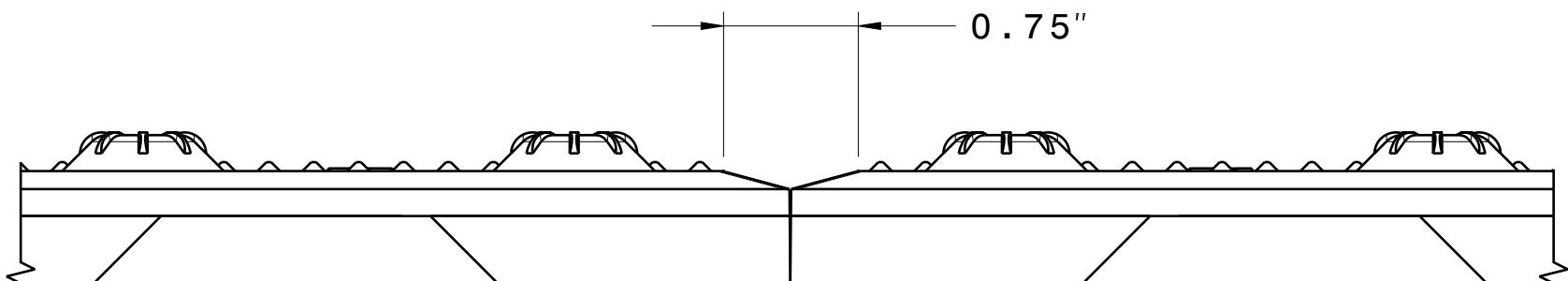

SIDE VIEW: 2-PANEL

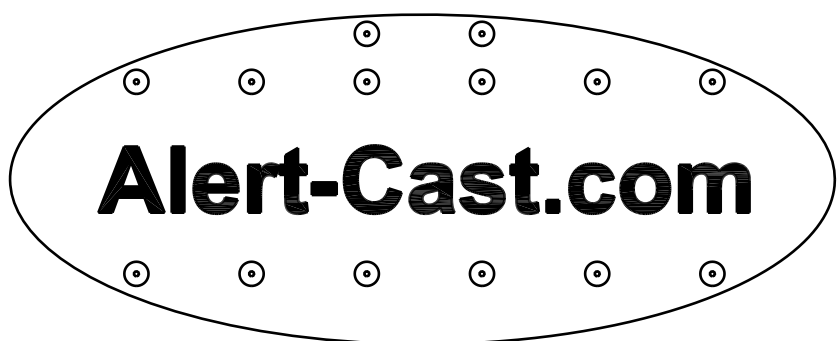

DETAIL B
(VIEW ROTATED)

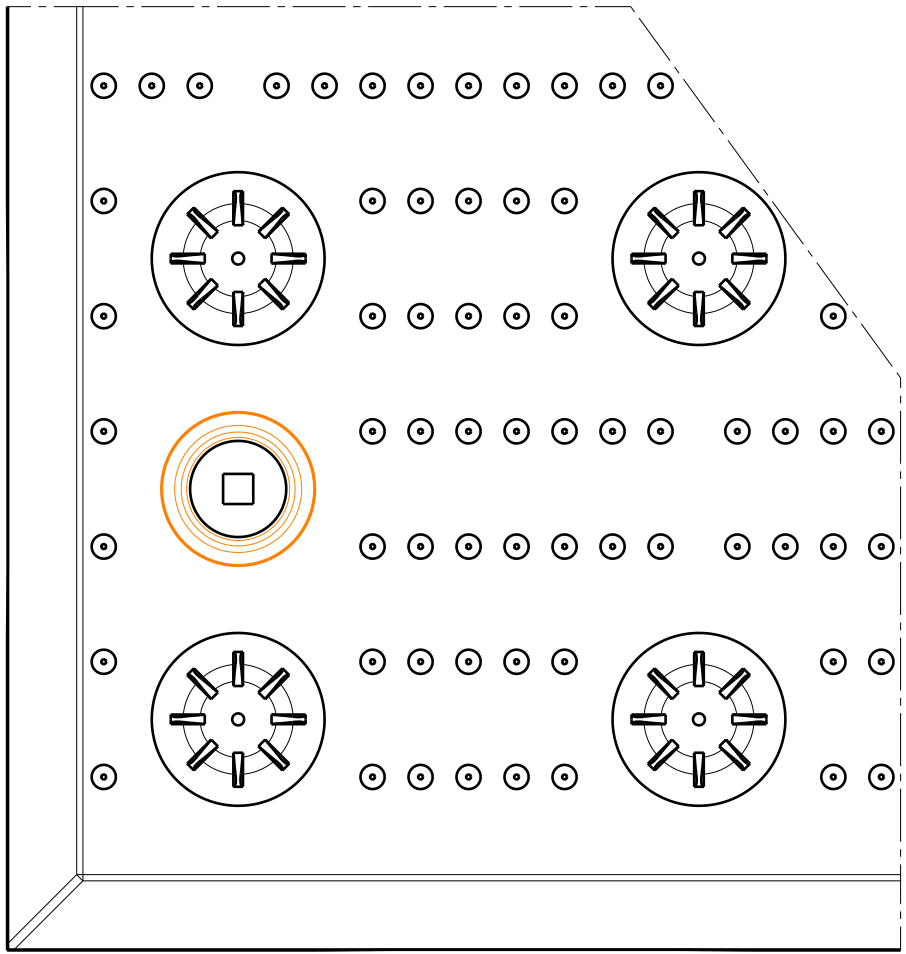

DETAIL A
(Field area micro-domes closeup)

PLAN VIEW

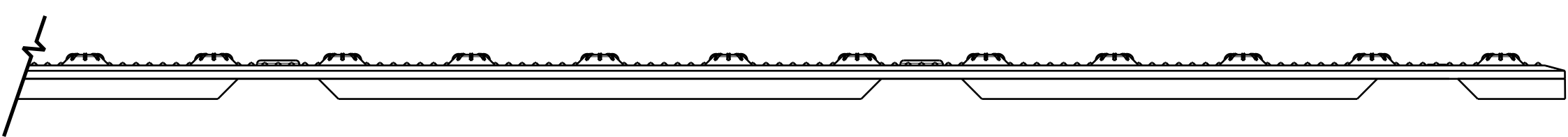

SIDE VIEW

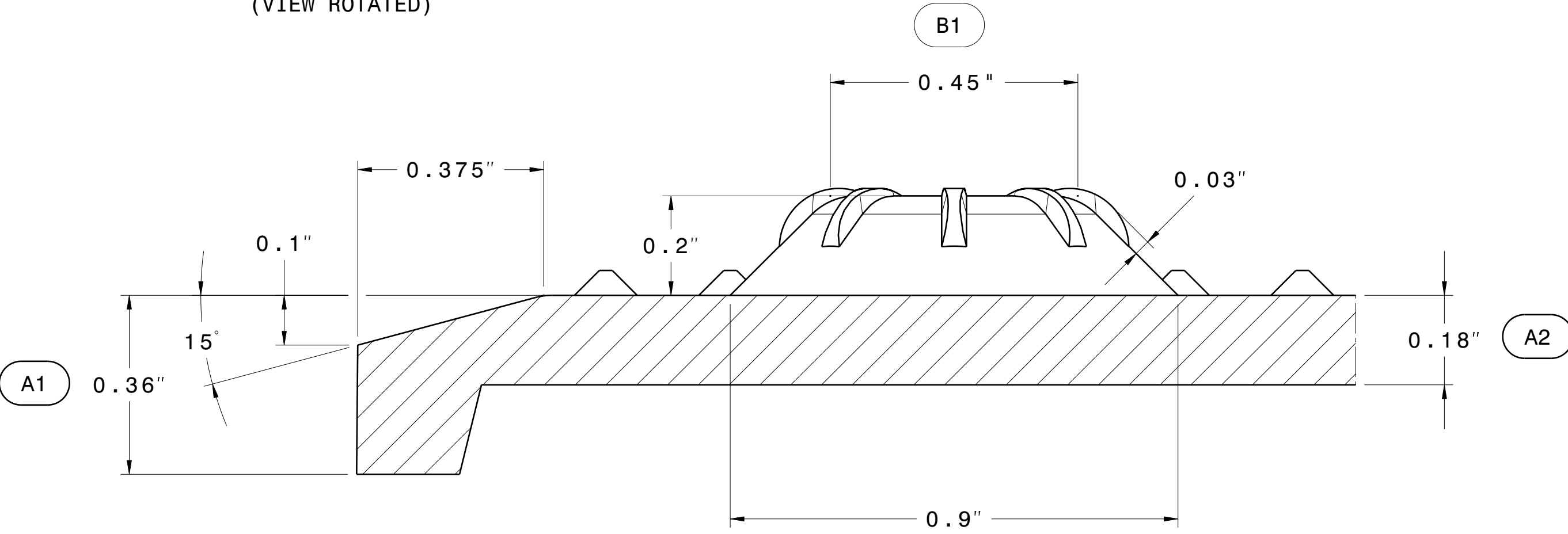

Section view A-A

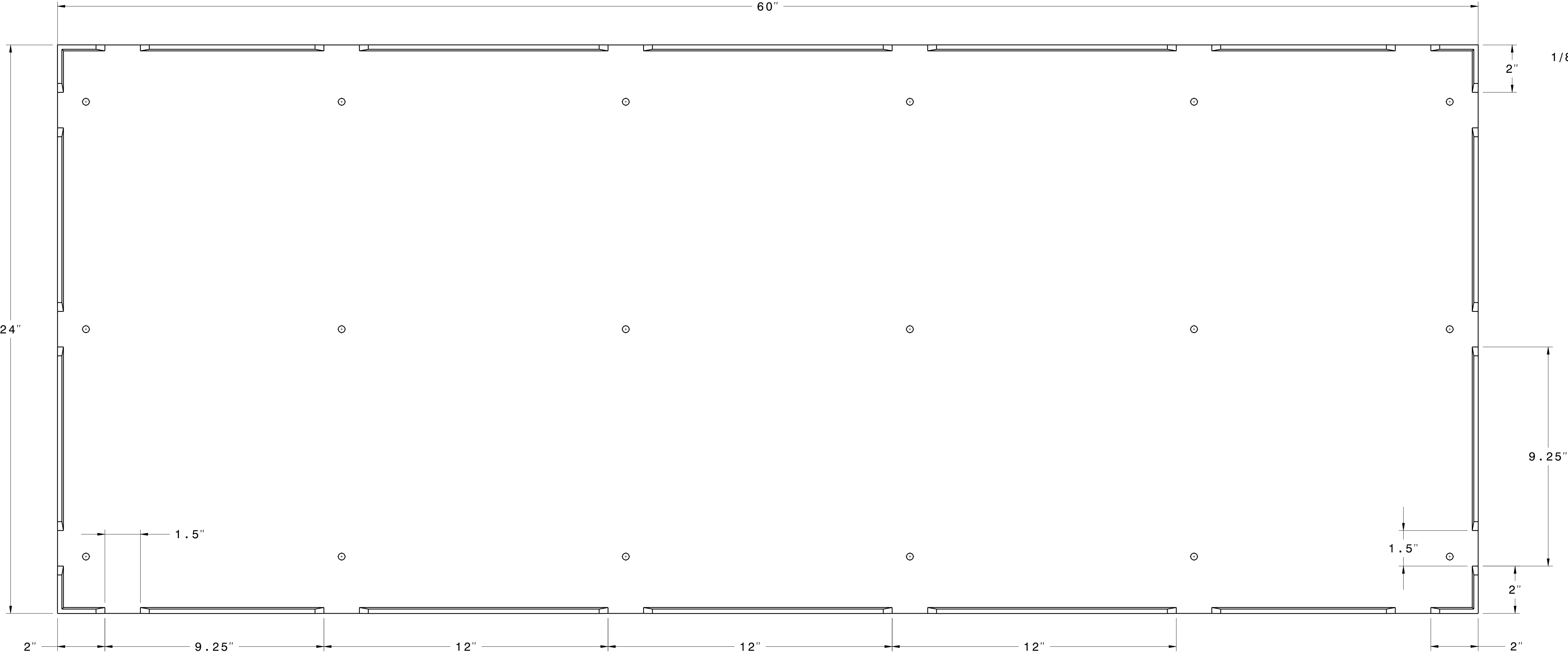

UNDERSIDE VIEW

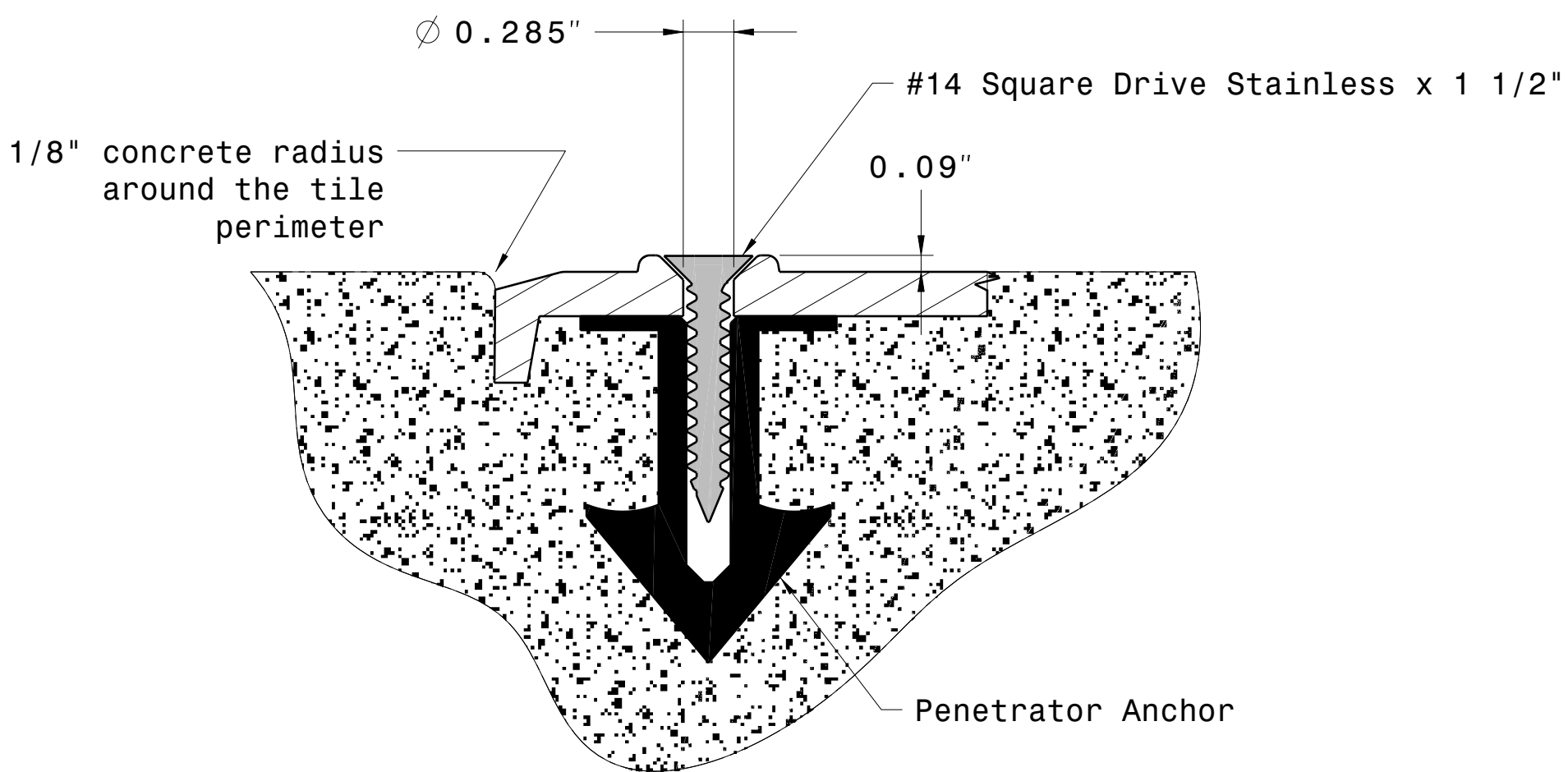

TYPICAL PERIMETER FASTENER DETAIL

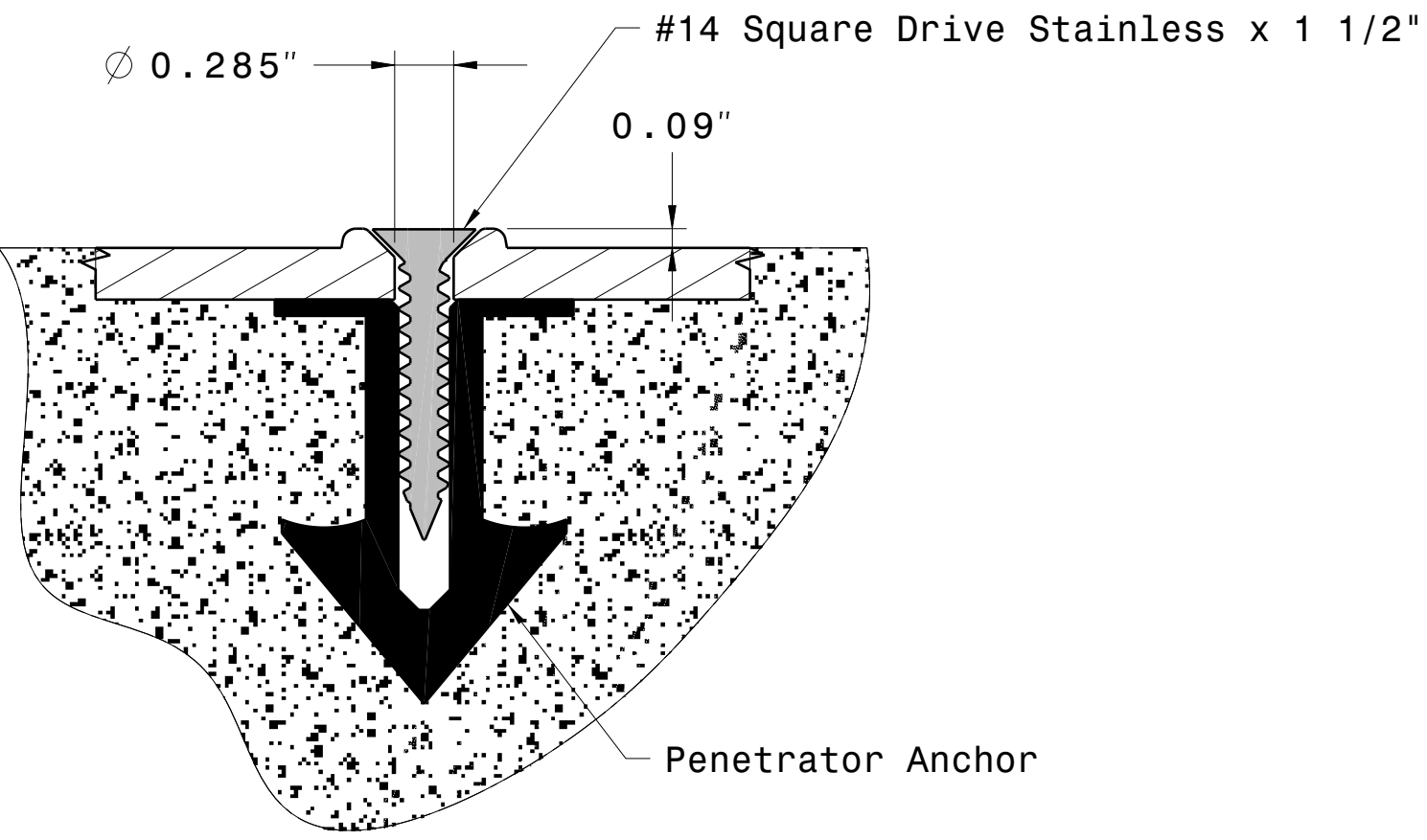

TYPICAL INTERIOR FASTENER DETAIL

www.alerttile.com
877-232-6287

SUBJECT

alertcast
Detectable Warning System

TRUNCATED DOME, DETECTABLE
WARNING TACTILE SURFACE

MATERIAL LIST			
ITEM	Description	PART No.	QTY
1	AlertCast Panel	AC-2460-XX	1
2	Stainless Screw	Alert Screw	18
3	Penetrator Anchor	PA-1	18

REVISION HISTORY

REV.	DATE	DESCRIPTION	APPROVED
A	10/12/11	1-Dimension was 0.625"	AM
		2-Dimension was 0.25"	
B	10/22/12	1-Added Dome dimension	AM

APPROVALS	INT	DATE
DESIGNED	AM	05/05/2010
DRAWN	RDD	05/11/2010
CHECKED	AM	05/14/2010

UNLESS OTHERWISE SPECIFIED
DIMENSIONS ARE IN INCHES
TOLERANCES: +/- 0.050"
ANGLES: +/- 1 deg.

THIRD ANGLE PROJECTION
DO NOT SCALE PRINT

PROJECT

alertcast
Detectable Warning System

TRUNCATED DOME, DETECTABLE
WARNING TACTILE SURFACE
2x5 CAST IN PLACE *replacable*
INLINE DOME TILE DRAWING.

DRAWING NUMBER	REV
AC-2460	B